

Existing Archway
to be retained
See Drawing:
PGATE-ZZ-ZZ-A-HTG-31139

Existing Turret
to be retained
See Drawing:
PGATE-ZZ-DR-A-HTG-31133

Existing Quay Wall
to be retained
See Drawing:
PGATE-ZZ-ZZ-DR-A-HTG-31132

Existing Tower
to be retained
See Drawing:
PGATE-ZZ-ZZ-DR-A-HTG-31134

Existing River Building
to be retained:
See Drawing
PGATE-ZZ-ZZ-DR-A-HTG-31136

Existing Buildings
1 : 200

Notes:
DO NOT SCALE FROM THIS DRAWING. USE FIGURED DIMENSIONS
IN ALL CASES. VERIFY DIMENSIONS ON SITE AND REPORT ANY
DISCREPANCIES TO THE ARCHITECTS IMMEDIATELY. THIS
DRAWING TO BE READ IN CONJUNCTION WITH THE ARCHITECTS
SPECIFICATION. © THIS DRAWING IS COPYRIGHT AND MAY ONLY
BE REPRODUCED WITH THE ARCHITECTS PERMISSION.

OSI License Number - AR 0052219
Projection / Spatial Reference:
Projection: IRENET19 Irish Transverse Mercator
Centre Point Coordinates:
X,Y = 713657.3699 734403.2446
Reference Index:
Map Series / Map Sheets
1:1,000 | 3263-02
1:1,000 | 3263-08
1:1,000 | 3263-07
1:1,000 | 3263-03
Vertical Datum:
MALIN HEAD

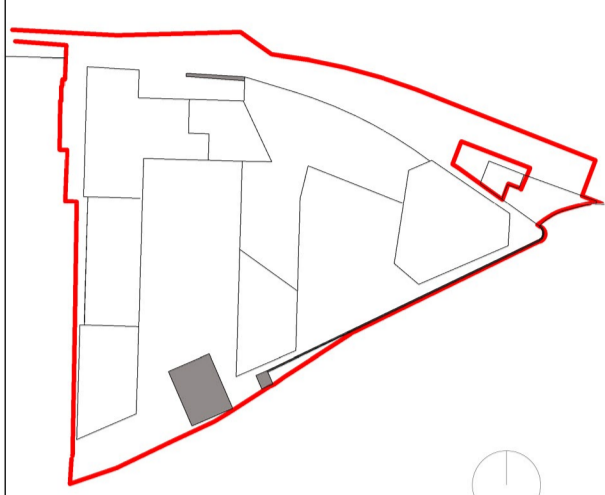

PLANNING LEGEND

SYMBOL	DESCRIPTION
	SITE BOUNDARY LINE
	EXISTING STRUCTURES
	PROPOSED DEMOLITION
	PROPOSED DEMOLITION OF EXISTING BUILDINGS

P02	29.11.24	EOB	Planning
-----	----------	-----	----------

Rev	Date	DRN	Description

Reddy Architecture + Urbanism
Dartly Road
Dublin 6, D06 Y0E3
T: +353 (0)1 4987000
W: www.reddyarchitecture.com
E: info@reddyarchitecture.com

Client Details:
Ruirside Developments Ltd.

Project Details:
PGATE
42A Parkgate Street, Dublin 8

Drawing Title:
Existing Buildings

Job No P24-216D	Date 29.11.24	Scale@A1 1:200
Status Planning	Drawn By J.Basquel	
Purpose Planning Permission	Checked By E.O'Brien	
Drawing Number PGATE-RAU-ZZ-ZZ-DR-A-HTG-31130	Revision P02	

